

**ON-SITE SEWERAGE SYSTEM FOR:
7379 FINTRY DELTA ROAD, KELOWNA BC**

LEGAL: LOT 86, DL 686 PLAN 15529, ODYD
 CIVIC: 7379 FINTRY DELTA ROAD,
 KELOWNA BC
 PID: 008-844-500
 ROLL: 19-723-13293.000
 OWNER: TIM ROBINSON



KEYPLAN

NOTES:

1. THE SEPTIC TANK SHALL BE LOCATED TO PROVIDE A MIN. FALL OF 1/8" PER FOOT IN ALL BUILDING SEWER DRAINS AND PLACED ON UNDISTURBED NATIVE SOIL.
2. ROOF AND SITE DRAINAGE SHOULD BE DIVERTED AWAY FROM TANK AND FIELD AREA.
3. THE SEPTIC TANK SHALL BE INSPECTED AND PUMPED EVERY 3 TO 5 YEARS DEPENDING, ON HOME OCCUPANCY.
4. THE DISPOSAL FIELD SHALL BE COVERED TO PROVIDE A MIN. 2% GRADE FOR SURFACE DRAINAGE AND BE PROPERLY SEEDING AND MAINTAINED.
5. THE SITE IS LIKELY TO REMAIN SUITABLE FOR ON-SITE DISPOSAL INDEFINITELY SUBJECT TO PROPER OPERATION, MAINTENANCE, AND PARTS REPLACEMENT.
6. WATER-SAVING DEVICES AND PRACTICES SHOULD BE IMPLEMENTED.
7. A GARBARATOR SHOULD NOT BE USED WITH THIS SEPTIC SYSTEM.
8. THE OUTLET FILTER SHOULD BE INSPECTED QUARTERLY OR AS EXPERIENCE DICTATES.
9. BACKWASH FROM WATER TREATMENT OR SOFTENING SYSTEMS SHOULD NOT BE DISCHARGED TO THIS SEWERAGE SYSTEM.

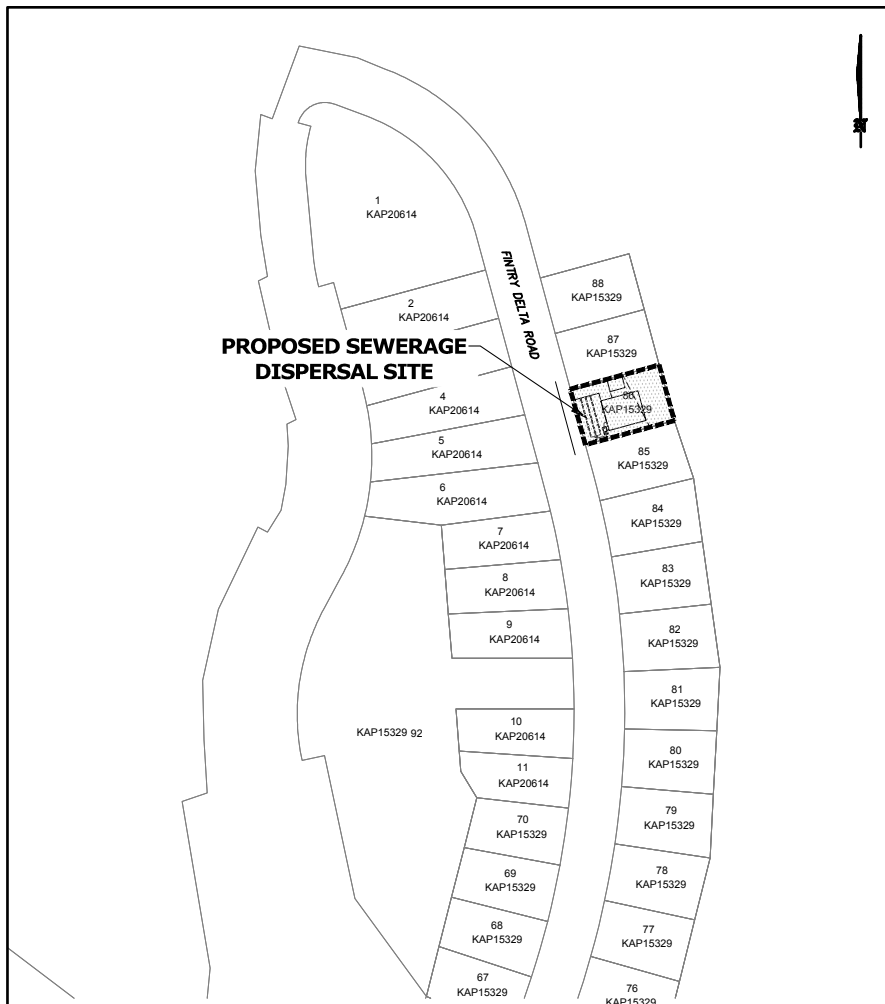

LOCATION PLAN

SCALE 1:3000

ISSUED FOR REVIEW

DATE: Aug. 15, 2019

ISSUED FOR CONSTRUCTION

DATE: _____

ASBUILT INSPECTION

DATE: _____

DRAWN BY: W.G.S.

DATE: Aug. 15, 2019



1805 Capistrano Drive
 Kelowna, BC V1V 2Z3
 CELL: (250) 862-6322 PHONE: (778) 753-6586
 EMAIL: jeff@OlandEngineering.ca
 WEBSITE: http://OlandEngineering.ca

C. JEFFREY OLAND, P.ENG.

DATE:

ON-SITE SEWERAGE SYSTEM FOR:
7379 FINTRY DELTA ROAD, KELOWNA BC

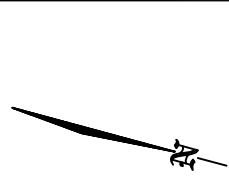
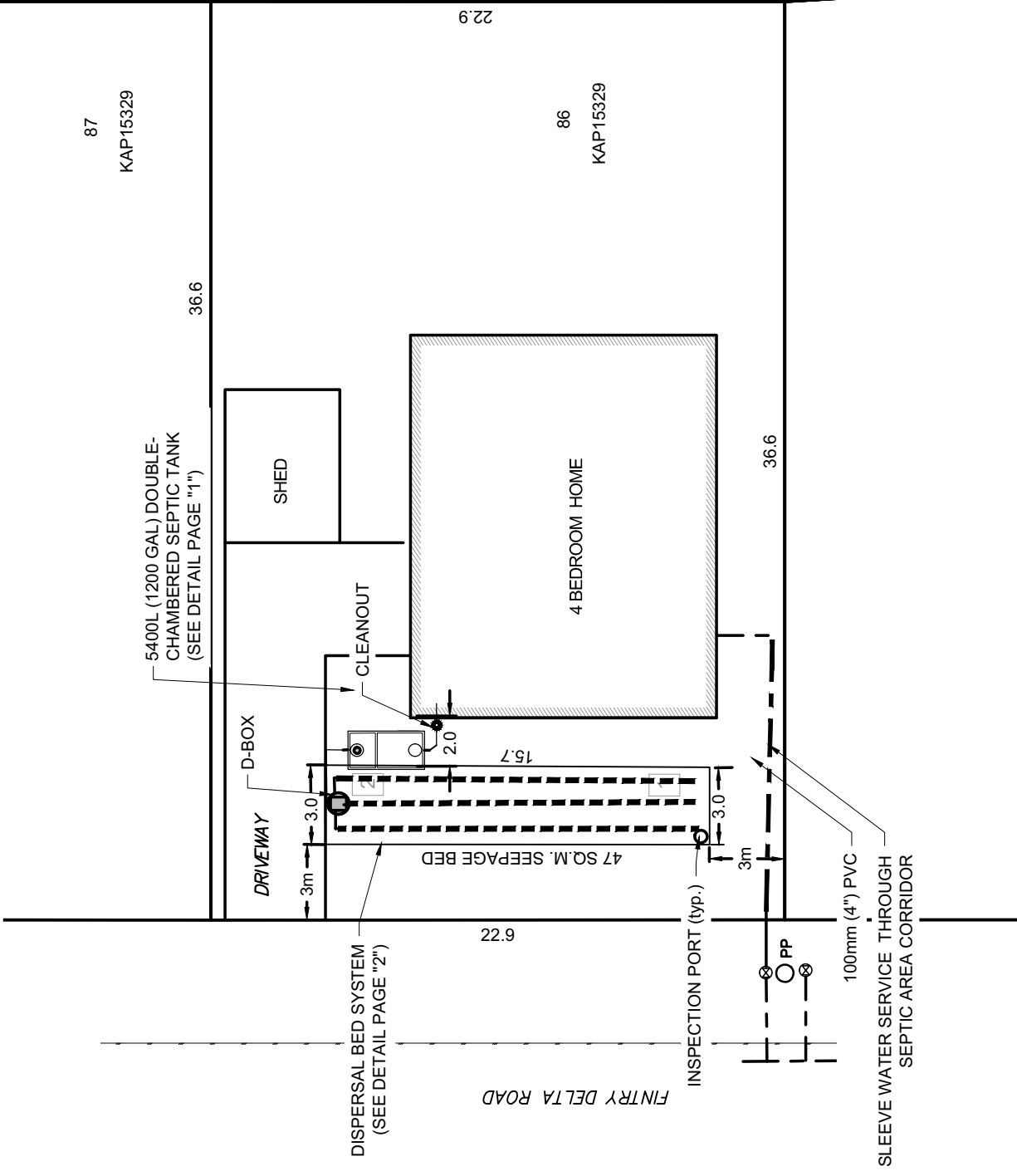

OLAND ENGINEERING LIMITED
 1805 Capistrano Drive
 Kelowna, BC V1V 2Z3
 CELL: (250) 862-6322 PHONE: (778) 753-6586
 EMAIL: jeff@OlandEngineering.ca
 WEBSITE: http://OlandEngineering.ca

1 SITE PLAN
 SCALE: 1:250



87
KAP15329

36.6

22.9

86
KAP15329

85
KAP15329

ON-SITE SEWERAGE SYSTEM FOR:

7379 FINTRY DELTA ROAD, KELOWNA BC

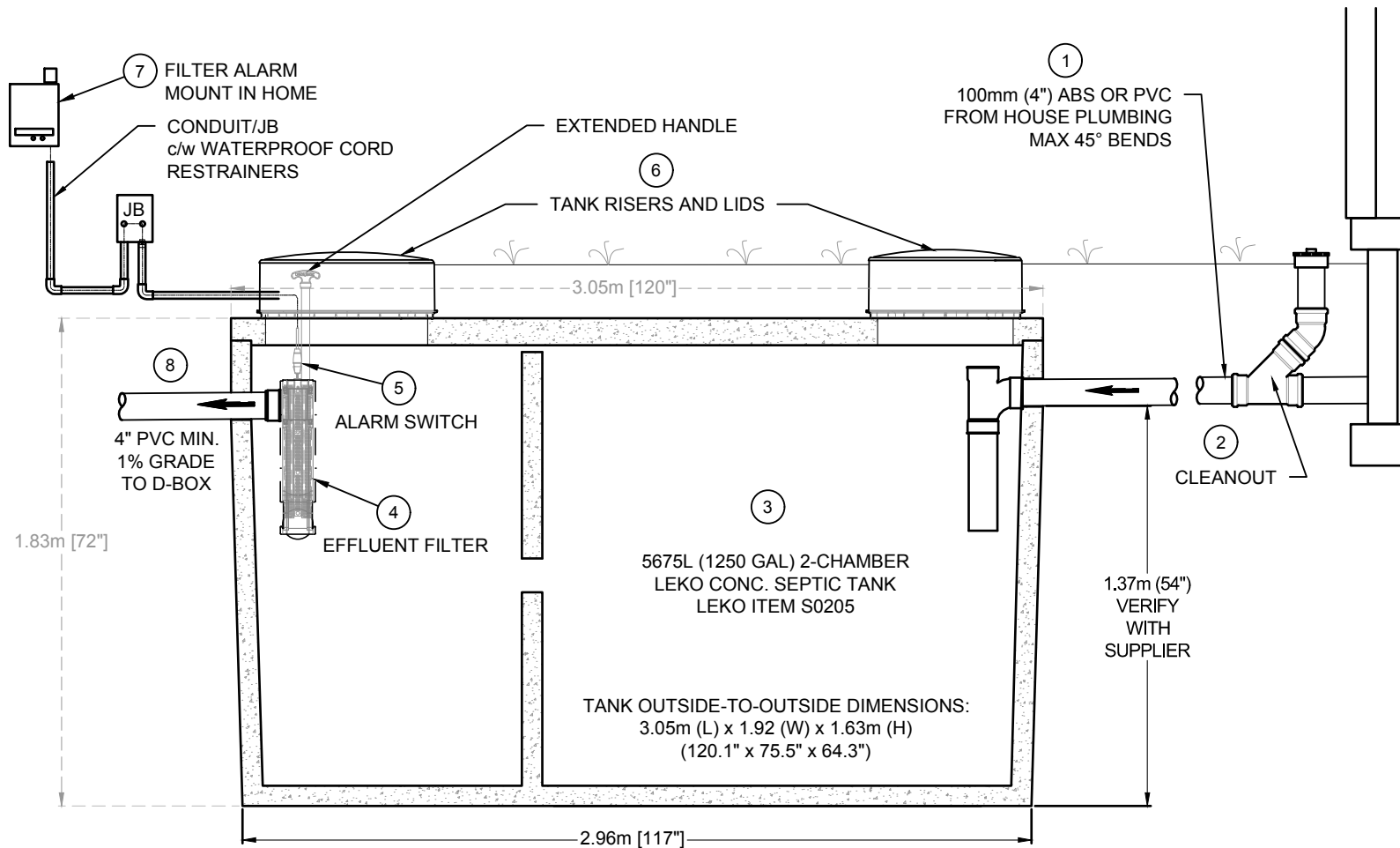

1 **TANK DETAIL**
SCALE: 1:25



1805 Capistrano Drive
Kelowna, BC V1V 2Z3
CELL: (250) 862-6322 PHONE: (778) 753-6586
EMAIL: jeff@OlandEngineering.ca
WEBSITE: <http://OlandEngineering.ca>

****NOTE:**

COMPACT ALL BACKFILL AROUND TANK
AND UNDER PIPE IN MAX. 300mm LIFTS

C. JEFFREY OLAND, P.ENG.
DATE:

ON-SITE SEWERAGE SYSTEM FOR:
7379 FINTRY DELTA ROAD, KELOWNA BC

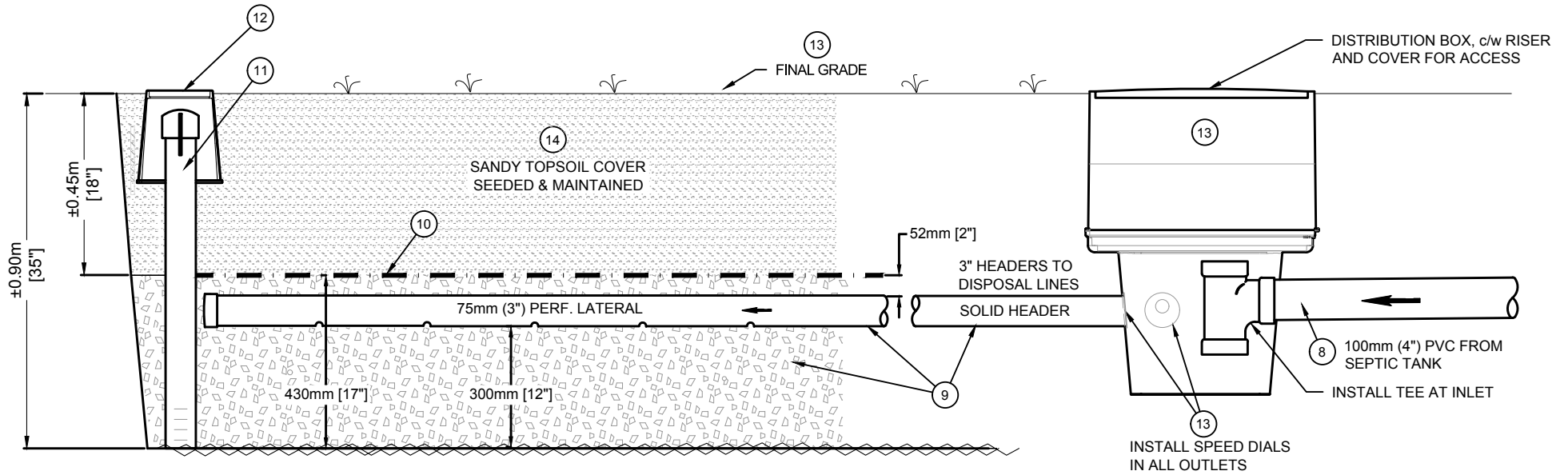

1 DISPERSAL SYSTEM PROFILE
 SCALE: 1:15



1805 Capistrano Drive
 Kelowna, BC V1V 2Z3
 CELL: (250) 862-6322 PHONE: (778) 753-6586
 EMAIL: jeff@OlandEngineering.ca
 WEBSITE: <http://OlandEngineering.ca>

C. JEFFREY OLAND, P.ENG.
 DATE:

ON-SITE SEWERAGE SYSTEM FOR:
7379 FINTRY DELTA ROAD, KELOWNA BC

MATERIALS LIST

1. 100mm (4") ABS OR PVC SEWER OUTLET AS SPECIFIED BY THE B.C. PLUMBING CODE MIN. 1% GRADE, MAX. 45° BENDS BED AND COMPACT UNDER ALL PIPING
2. 100mm (4") CLEANOUT, EXPOSED FOR EASY LOCATE AND ACCESS
3. 5400L (1200 IMP. GAL.) DOUBLE-CHAMBERED APPROVED SEPTIC TANK (LEKO S0205 SHOWN)
4. POLYLOK FILTER ASSEMBLY MODEL PL-122, c/w EXTENDED HANDLE
5. POLYLOK SMART FILTER CONTROL SWITCH. CONNECT TO ALARM IN PANEL
6. 1 x 54cm (20") & 1 x 60cm (24") PLASTIC ACCESS RISERS & COVER c/w EXTENSIONS AS REQ'D (MAX. 1m)
7. SJ E-RHOMBUS TANK ALERT XT ALARM SYSTEM INSTALLED AS PER ELECTRICAL CODE (115V OUTLET)
8. 10m± OF 100mm (4") SEWER PVC PLUS MISC. ELBOWS AS REQUIRED FOR ROUTING TO SEPTIC TANK, AND FROM TANK TO D-BOX
9. 1m WIDE TRENCHES WITH 300mm (12") DRAIN ROCK UNDER 3" PERF. PIPE, AND MIN. 50mm (2") COVER OF CLEAN DRAIN ROCK, 15mm TO 65mm SIZE RANGE. QUANTITIES AS FOLLOWS:
 - 9.1. 19.7m³ DRAIN ROCK
 - 9.2. 46m OF CSA APPROVED 3" PVC PERF. PIPE & 6m SOLID 3" PVC HEADERS
10. COVER DRAIN ROCK WITH NON-WOVEN, 160N GEOTECH FILTER FABRIC (46m²)
11. 3 x 75mmØ (or 100mmØ) x 0.8m HIGH INSPECTION PORTS, c/w LOOSE FITTING CAPS AND SLOTS NEAR BOTTOM (DO NOT GLUE CAPS). PLACE 25mm REBAR BESIDE INSPECTION PORT AND JUST BELOW GRADE FOR LOCATION BY METAL DETECTOR
12. 3 x IRRIGATION BOXES TO HOUSE INSPECTION PORTS
13. 1 X 8 OUTLET DISTRIBUTION BOX c/w SPEED DIALS AND RISER TO SURFACE. INSTALL 75mm (3") TEE AT INLET AS SHOWN
14. 450 mm (18") MIN. SANDY TOPSOIL COVER



1805 Capistrano Drive
Kelowna, BC V1V 2Z3
CELL: (250) 862-6322 PHONE: (778) 753-6586
EMAIL: jeff@OlandEngineering.ca
WEBSITE: <http://OlandEngineering.ca>

C. JEFFREY OLAND, P.ENG.
DATE:

ON-SITE SEWERAGE SYSTEM FOR:

7379 FINTRY DELTA ROAD, KELOWNA BC



**OLAND
ENGINEERING
LIMITED**

SOIL LOG

PROJECT: Robinson, Tim
LOT 86, 7379 FINTRY DELTA ROAD, KELOWNA BC

JOB: 19-044
DATE: August 14, 2019

TEST PIT # **1**

Depth [m]		TEXTURE	STRUCTURE		CONSISTENCY	COLOR	CF %	
From	To		Type	Grade			%	[mm]
0.0	0.3	Topsoil			Dry	Black	0%	0
0.3	1.2	Loamy Sand	Granular	Fine	Dry	Tan	0%	0
1.2	1.6	Sand	Granular	Medium	Dry	Light Brown	0%	0
1.6		Gravel	Granular		Dry		100%	25

Notes: Perc. Rate 2 min./in. @ 0.7m & 1 min./in @ 1.2m (S side of lot)

TEST PIT # **2**

Depth [m]		TEXTURE	STRUCTURE		CONSISTENCY	COLOR	CF %	
From	To		Type	Grade			%	[mm]
0.0	0.2	Topsoil			Dry	Black	0%	0
0.2	0.8	Loamy Sand	Granular	Fine	Dry	Tan	0%	0
0.8	1.5	Sand	Granular	Medium	Dry	Light Brown	0%	0
1.5		Gravel	Granular		Dry		100%	25

Notes: Same soil structure and perc rate as Test Pit location #1 (N side of lot)

CALCULATIONS:

DDF = 4 BEDROOM HOME = 1,600L/DAY

HLR = 35 L/m²/d

INFILTRATIVE AREA REQUIRED = 1,600 / 35 = 45.7 m²

DESIGN INFILTRATIVE AREA = 3 TRENCHES x 15.24m LONG x 1.0m WIDE = 45.7 m²

MINIMUM TANK SIZE = 3 x 1,600 = 4,800L

DESIGN TANK SIZE = 5,675L



1805 Capistrano Drive
Kelowna, BC V1V 2Z3
CELL: (250) 862-6322 PHONE: (778) 753-6586
EMAIL: jeff@OlandEngineering.ca
WEBSITE: http://OlandEngineering.ca

C. JEFFREY OLAND, P.ENG.
DATE: